

THE MAP DATA:

DISTRICT	0900
SECTION	100
TOWNSHIP	3
RANGE	19

SCHOOL DISTRICT: SAGAHONACK  
 DISTRICT OFFICE: BRIDGEPLANT

# MINOR SUBDIVISION

MAP OF PROPERTY

CLAUDIO DAL DIAZ

TOWNSHIP OF SAGAHONACK  
 COUNTY OF SULLY, NY

APPROVED  
 SOUTHWAMPTON TOWN ENGINEER

MAY 6 1976  
*[Signature]*

SCALE: 1"=100'  
 NEED 15 MORE ACRES

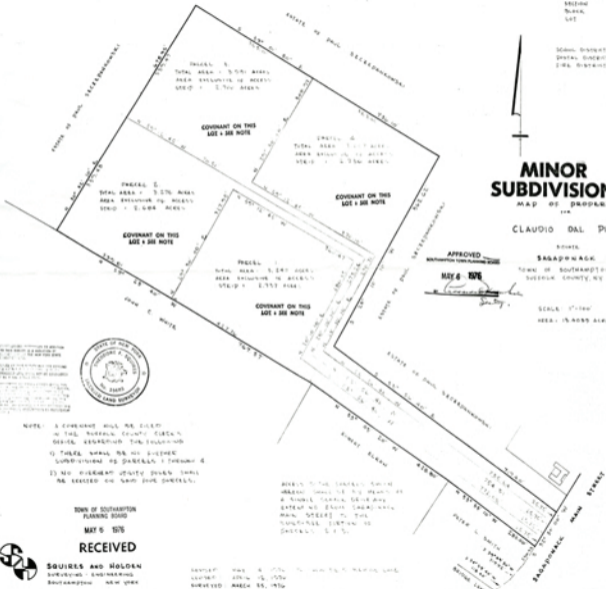

THIS PLAN IS SUBJECT TO THE  
 APPROVAL OF THE STATE ENGINEER  
 OF THE DEPARTMENT OF AGRICULTURE  
 AND MARKETS, DIVISION OF LAND  
 SURVEYING, AND TO THE APPROVAL  
 OF THE TOWN ENGINEER OF THE  
 TOWN OF SOUTHWAMPTON, NY.

- NOTE: A COVENANT WILL BE FILED  
 IN THE SULLY COUNTY CLERK'S  
 OFFICE, RESPECTING THE FOLLOWING:
- 1) THERE SHALL BE NO OTHER  
 SUBDIVISIONS OF PARCELS 1 THROUGH 3
  - 2) NO OVERMENT QUANTITY SHALL  
 BE RECEIVED ON SAID FOUR PARCELS.

REFER TO THE SHARPLEY SURVEY  
 MAPS TO SEE THE PRESENT AND  
 A SHARPLEY SURVEY MAP SHOWING  
 EXTENT OF SAID SHARPLEY  
 MAIN STREET TO THE  
 TOWNSHIPS BOUNDARY AS  
 SHOWN ON SAID MAP.

TOWN OF SOUTHWAMPTON  
 PLANNING BOARD  
 MAY 6 1976  
**RECEIVED**

**SQUIRES AND HOLDEN**  
 SURVEYORS - ENGINEERS  
 SOUTHWAMPTON NEW YORK

DESIGNED: MAY 6 1976  
 DRAWN: APRIL 15 1976  
 SURVEYED: MARCH 25 1976

