

SURVEY OF PROPERTY
 PROPERTY LOCATED AT WATER MILL
 LOT No. 17
 MAP OF REMI WESNOFSKE
 FILED: NOVEMBER 24, 1987; FILE No. 8434
 TOWN OF SOUTHAMPTON
 SUFFOLK COUNTY, NEW YORK
 S.C.T.M. # 900-080-02-05.22
 AREA = 40.009 SF. = 0.9185 ACRES
 SCALE: 1"=50'

NOTE: THE EXISTENCE OF RIGHT OF WAYS,
 WETLANDS AND/OR EASEMENTS OF RECORD
 IF ANY, NOT SHOWN ARE NOT GUARANTEED.

REFER TO S.C.D.H.S. STANDARDS DATED NOVEMBER 13, 1995,
 FOR SEPTIC TANK AND LEACHING POOL REQUIREMENTS AND
 COMPONENT DETAILS.

PROPOSED DWELLING TO HAVE EIGHT (8) BEDROOMS MAXIMUM.

SEPTIC TANK TO BE 2000 GALLON TYPICAL.

USE TWO (2) 10' DIAMETER, 10' HIGH PRECAST CONCRETE
 LEACHING RINGS, WITH ROOM FOR 50% EXPANSION.

BACKFILL MATERIAL SHALL BE COARSE SAND AND GRAVEL.

BOTTOM OF POOLS SHALL BE A MINIMUM OF 3' ABOVE
 SEASONAL HIGH GROUNDWATER.

SEASONAL POOL HOUSE TO HAVE

SEPTIC TANK TO BE 1000 GALLON TYPICAL.

LEACHING POOL TO BE STANDARD SINGLE POOL,
 8' DIAMETER, 4' EFFECTIVE DEPTH

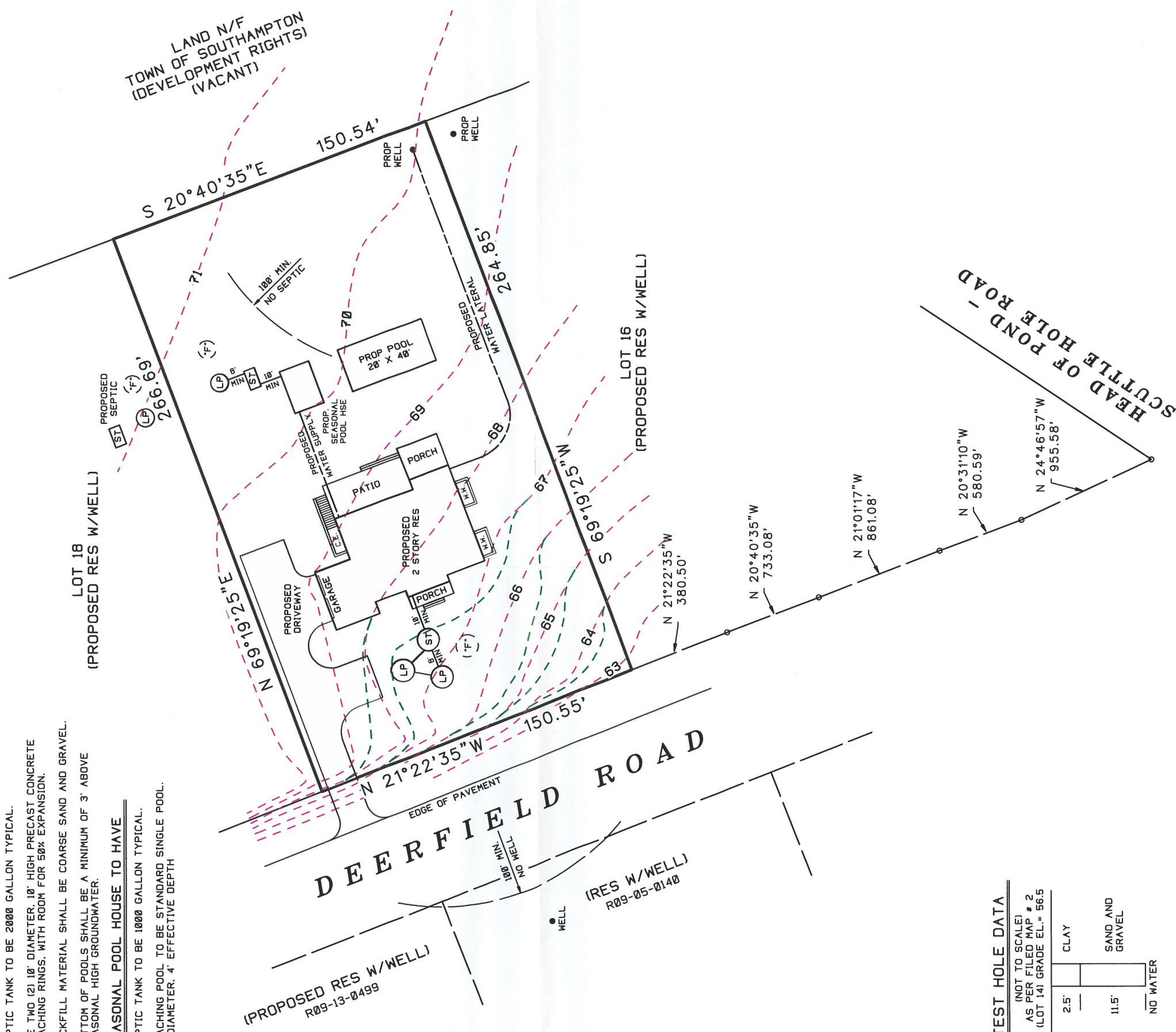

TEST HOLE DATA
 (NOT TO SCALE)
 AS PER FILLED MAP # 2
 (LOT 14) GRADE EL. = 56.5

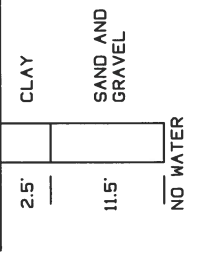

NOTE: TOPOGRAPHIC CONTOURS RESULT FROM
 AN ACTUAL FIELD SURVEY AND REFER TO
 APPROX N.A.V.D. 1988

--- EXISTING CONTOUR
 - - - PROPOSED CONTOUR

UNAUTHORIZED ALTERATION OR ADDITION TO THIS SURVEY IS A VIOLATION
 OF SECTION 17209 OF THE NEW YORK STATE EDUCATION LAW.

COPIES OF THIS SURVEY MAP NOT BEARING THE LAND SURVEYORS INKED
 OR EMBOSSED SEAL SHALL NOT BE CONSIDERED TO BE A VALID TRUE COPY.

GUARANTEES OR CERTIFICATIONS INDICATED HEREON SHALL RUN ONLY TO
 THE PERSON FOR WHOM THE SURVEY IS PREPARED, AND ON HIS BEHALF TO
 THE TITLE COMPANY, GOVERNMENTAL AGENCY AND LENDING INSTITUTION
 LISTED HEREON, AND TO THE ASSIGNEES OF THE LENDING INSTITUTION.
 GUARANTEES OR CERTIFICATIONS ARE NOT TRANSFERABLE TO ADDITIONAL
 INSTITUTIONS OR SUBSEQUENT OWNERS.

2894-H

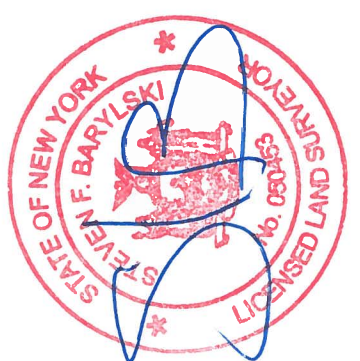

SURVEYED BY:
 STEVEN BARYLSKI
 N.Y.S. Lic. No. 050453
 P.O. BOX 6005
 SOUTHAMPTON, N.Y. 11969
 MARCH 19, 2014
 3-27-2014: ADD SITE PLAN
 PHONE: 631-283-4525 FAX: 631-283-4784
 STEVEN@SBLSPFC.COM