

SURVEY OF PROPERTY

Situate
Town Of East Hampton
Suffolk County, New York

SCALE: 1" = 50'

AREA: 87,876 sq. ft.
or 2.0174 acres

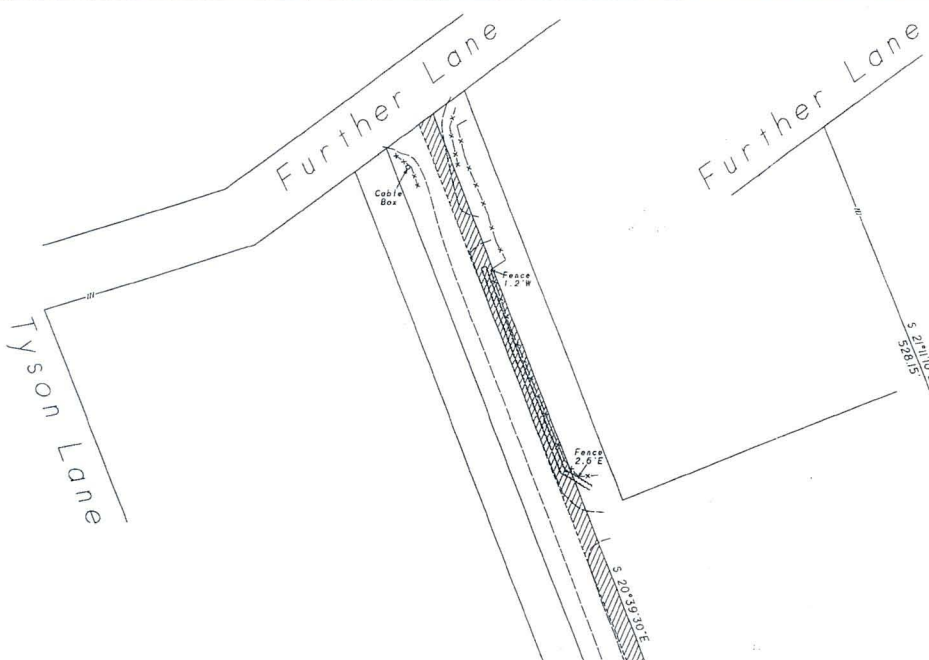
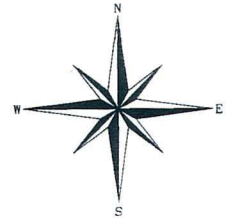

Certified only to:
Vinayak Singh
Ashu Singh

Land Now or Formerly of
Edward & Edward F. McLaughlin

9' Wide Private
Right-of-Way

Land Now or Formerly of
Wendy D'Ala, Esq. LLC

Land Now or Formerly of
Birch Tree Partners LLC

- indicates found iron spike.
- indicates set 12" iron pin.
- ⊗ indicates utility pole.

NOTES:

1. Unauthorized alteration or addition to a survey map bearing a licensed land surveyor's seal is a violation of section 7200, sub-division 2 of the N.Y. State Education Law.
2. Only copies from the original of this survey marked with an original of the land surveyor's embossed seal or inked seal shall be considered to be valid copies.
3. Certifications indicated hereon signify that this survey was prepared in accordance with the existing Code of Practice for Land Surveys adopted by the N.Y. State Association of Professional Land Surveyors. Said certifications shall run only to the person for whom the survey is prepared, and on his behalf to the Title company, governmental agency and Lending institution listed hereon, and to the assignees of the lending institution. Certifications are not transferable to additional institutions of subsequent owners.
4. Underground improvements or encroachments, if any, are not shown hereon.
5. The existence of right of ways, set-backs and/or easements of record, if any, not shown are not guaranteed.
6. All natural features shown on survey, including but not limited to Bluff Crest, Clearing, and Wetlands should be verified with the appropriate regulatory agency.



Surveyed: July 31, 2007
David L. Saskas
N.Y.S. Lic. No. 049960

Saskas Surveying Company, P.C.
124 Cedar Street
East Hampton, New York 11937
(631) 324-6917 FAX 329-4768