

THE WATER SUPPLY, WELLS, DRYWELLS AND CESSPOOL LOCATIONS SHOWN ARE FROM FIELD OBSERVATIONS AND OR DATA OBTAINED FROM OTHERS.

AREA: 841,169.35 SQ. FT. or 19.31 ACRES

ELEVATION DATUM: _____

UNAUTHORIZED ALTERATION OR ADDITION TO THIS SURVEY IS A VIOLATION OF SECTION 2209 OF THE NEW YORK STATE EDUCATION LAW. COPIES OF THIS SURVEY MAP NOT BEARING THE LAND SURVEYOR'S EMBOSSED SEAL SHALL NOT BE CONSIDERED TO BE A VALID TRUE COPY. GUARANTEES INDICATED HEREON SHALL RUN ONLY TO THE PERSON FOR WHOM THE SURVEY IS PREPARED AND ON HIS BEHALF TO THE TITLE COMPANY, GOVERNMENTAL AGENCY AND LENDING INSTITUTION LISTED HEREON, AND TO THE ASSIGNEES OF THE LENDING INSTITUTION. GUARANTEES ARE NOT TRANSFERABLE. THE OFFSETS OR DIMENSIONS SHOWN HEREON FROM THE PROPERTY LINES TO THE STRUCTURES ARE FOR A SPECIFIC PURPOSE AND USE THEREFORE THEY ARE NOT INTENDED TO MONUMENT THE PROPERTY LINES OR TO GUIDE THE ERECTION OF FENCES, ADDITIONAL STRUCTURES OR AND OTHER IMPROVEMENTS. EASEMENTS AND/OR SUBSURFACE STRUCTURES RECORDED OR UNRECORDED ARE NOT GUARANTEED UNLESS PHYSICALLY EVIDENT ON THE PREMISES AT THE TIME OF SURVEY

SURVEY OF: LOT 2
 MAP OF: ROBERT ENTENMANN
 FILED: NOV. 09, 2006 No. 11461
 SITUATED AT: JAMESPORT
 TOWN OF: RIVERHEAD
 SUFFOLK COUNTY, NEW YORK

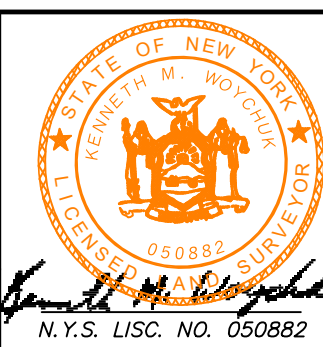

CERTIFIED TO: IBF FARM LLC;

KENNETH M. WOYCHUK LAND SURVEYING, PLLC
 Professional Land Surveying and Design
 P.O. Box 153 Aquebogue, New York 11931
 PHONE (631) 298-1688 FAX (631) 298-1688

FILE # 225-18 SCALE: 1"=60' DATE: JAN. 28, 2025

N.Y.S. LIC. NO. 050882