

GENERAL NOTES:

1. THE DESIGN ENGINEER SHALL OBSERVE THE OWTs PRIOR TO BACKFILL AND DURING SYSTEM STARTUP.
2. THE OWTs INSTALLER SHALL HOLD APPROPRIATE ENDORSEMENTS FROM SUFFOLK COUNTY DEPARTMENT OF HEALTH AND SHALL BE AN AUTHORIZED INSTALLER.
3. THE OWTs INSTALLER SHALL REGISTER THE ONSITE TREATMENT SYSTEM WITH SUFFOLK COUNTY DEPARTMENT OF HEALTH. THE ENGINEER OF RECORD SHALL PROVIDE RECORD DOCUMENTS AS REQUIRED BY SCOH.
4. AN EXECUTED OPERATION AND MAINTENANCE CONTRACT BETWEEN THE MAINTENANCE PROVIDER AND THE PROPERTY OWNER SHALL BE PROVIDED TO THE SCOH.
5. A GARBAGE GRINDER SHALL NOT BE INSTALLED UPSTREAM OF THE OWTs.
6. OWTs SHALL BE TESTED FOR WATER TIGHTNESS PRIOR TO ARRIVAL TO THE SITE USING A METHOD APPROVED BY THE MANUFACTURER.
7. ALL ELECTRICAL LINES FROM THE DWELLING TO THE CONTROL PANEL AND FROM THE CONTROL PANEL TO THE JUNCTION BOX SHALL BE SEALED AND WATER TIGHT.
8. CONTROL PANEL TO BE SET ON A PRECAST CONCRETE PIEDestal AND SET 2 INCHES ABOVE GRADE TO PREVENT WATER INTRUSION.
9. OWTs SHALL BE LOCATED MINIMUM 3'-0" FROM THE DRIVEWAY. A 6 INCH HIGH PRECAST CURB SHALL BE INSTALLED IN-BETWEEN THE DRIVEWAY AND THE OWTs IF 3 FEET SEPARATION CANNOT BE MAINTAINED.
10. NEW 1/4 OWT SYSTEM TO BE VENTED THROUGH PLUMBING, NO HOUSE TRAP TO BE INSTALLED.

PARCEL INFORMATION:

LOT 116 HAY BEACH POINT SECT. 4
 SITUATE: SOUTHAMPTON
 TOWN OF SHELTER ISLAND
 SUFFOLK COUNTY NY

TAX MAP NO. 700-01-02-17
 TOTAL AREA 43,969 SQ.FT. = 1.009 ACRES
 FILED OCT. 30, 1987
 AS MAP # 4963
 REVISIONS:
 3-12-2021 - UPDATED

SITE PLAN BASED ON SURVEY PREPARED BY:

Surveyed: MAY 14, 2018
 Jeffrey W. Haderer, L.S.
 TWIN FORKS LAND SURVEYING
 158 W. MONTAUK HIGHWAY, UNIT E3
 HARTFORD BAY, NEW YORK 11949
 (631) 369-8312 FAX: (631) 369-8313

SANITARY SYSTEM INFORMATION:

TOTAL NUMBER OF BEDROOMS: 4
 VA SIZE REQUIRED: 440 GPD
 LEACHING REQUIRED: 300FT³
 PROPOSED SEPTIC SYSTEM:
 (1) HYDRO ACTION AN-400 (440GPD PROPOSED)
 (1) 8'-0" Ø x 12'-0" DEEP LEACHING POOL(301 FT³ PROPOSED)

NOTE:

- EXISTING SEPTIC TO BE REMOVED.
- IMPROVED WELL & SANITARY IN EXCESS OF 150'
- NO SURFACE WATER EVIDENT WITHIN 300'

TEST HOLE # 4
 AS PER SUBDIVISION MAP
 HAY BEACH POINT SECT. 4
 FILE # 4963 DATE: OCTOBER 30, 1987

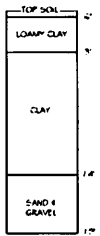

SEE ATTACHED SPECIAL CONDITION,
 GRADING PLAN AND/OR PLOT PLAN.

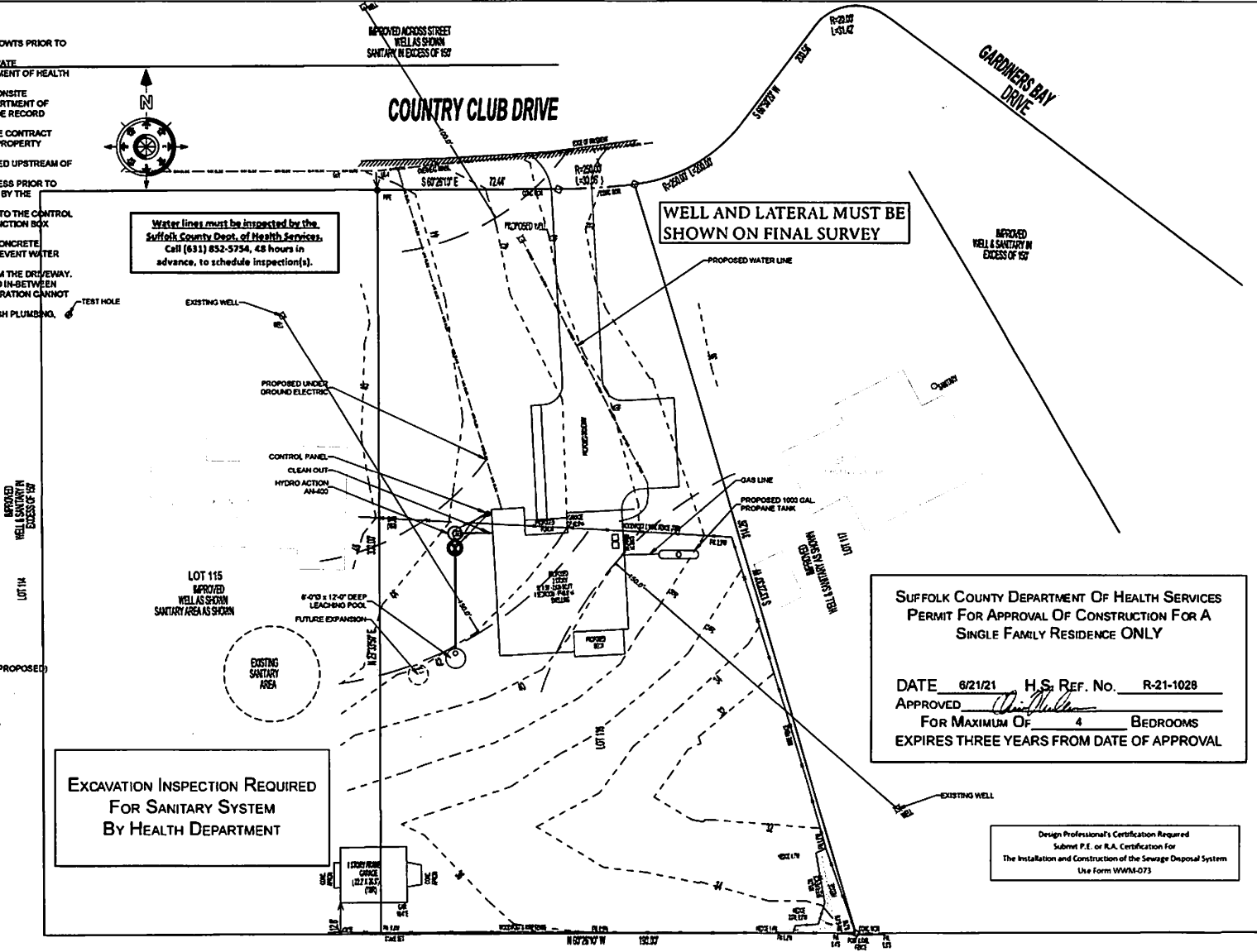
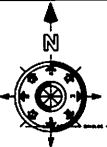

Water lines must be inspected by the
 Suffolk County Dept. of Health Services.
 Call (631) 632-5734, 48 hours in
 advance, to schedule inspection(s).

WELL AND LATERAL MUST BE
 SHOWN ON FINAL SURVEY

Excavation Inspection Required
 For Sanitary System
 By Health Department

SUFFOLK COUNTY DEPARTMENT OF HEALTH SERVICES
 PERMIT FOR APPROVAL OF CONSTRUCTION FOR A
 SINGLE FAMILY RESIDENCE ONLY

DATE 6/21/21 H.S. REF. No. R-21-1028
 APPROVED *[Signature]*
 FOR MAXIMUM OF 4 BEDROOMS
 EXPIRES THREE YEARS FROM DATE OF APPROVAL

Design Professional's Certification Required
 Submit P.E. or P.A. Certification for
 The Installation and Construction of the Sewage Disposal System
 Use Form WWNS-073

PROPOSED SEPTIC PLAN
 SCALE: 1" = 20'
 ELEVATIONS SHOWN ARE BASED ON USC AND OS DATUM (NAD 1984)

DiLandro Andrews
 128 County Rd. 29
 Suite 10
 Southampton, N.Y. 11964
 Office/Fax (631) 233-3929



PROJECT:
 58 COUNTRY CLUB DRIVE
 SHELTER ISLAND, N.Y. 11965
 S.C.T.M.# 700-1-2-17

PROJECT:
 1/4 OWT SEPTIC DESIGN
 HYDRO ACTION AN-400
 8'-0" Ø x 12'-0" DEEP
 LEACHING GALLEYS

No.	Date	Description
1	10/23/2021	ISSUE FOR NOI
2	6/21/2021	WELL LOCATION
3		
4		
5		

Designed By: PD
 Drawn By: JL
 Checked By: PD

Date: 6/19/2021
 Scale: NOTED

C-1

Sheet #