

FIRST FLOOR PLAN

First Floor: 1,932 Sq Ft
Back Patio: 1,266 Sq Ft
Front Patio: 265 Sq Ft
Basement: 363 Sq Ft
Crawlspace: 802 Sq Ft

Floor plan, furniture, and fixture measurements and dimensions are approximate and are for illustrative purposes only. Corcoran gives no guarantee, warranty or representation as to the accuracy and completeness of the floor plan

76 Jack & Jill Dr, Bridgehampton, NY 11932

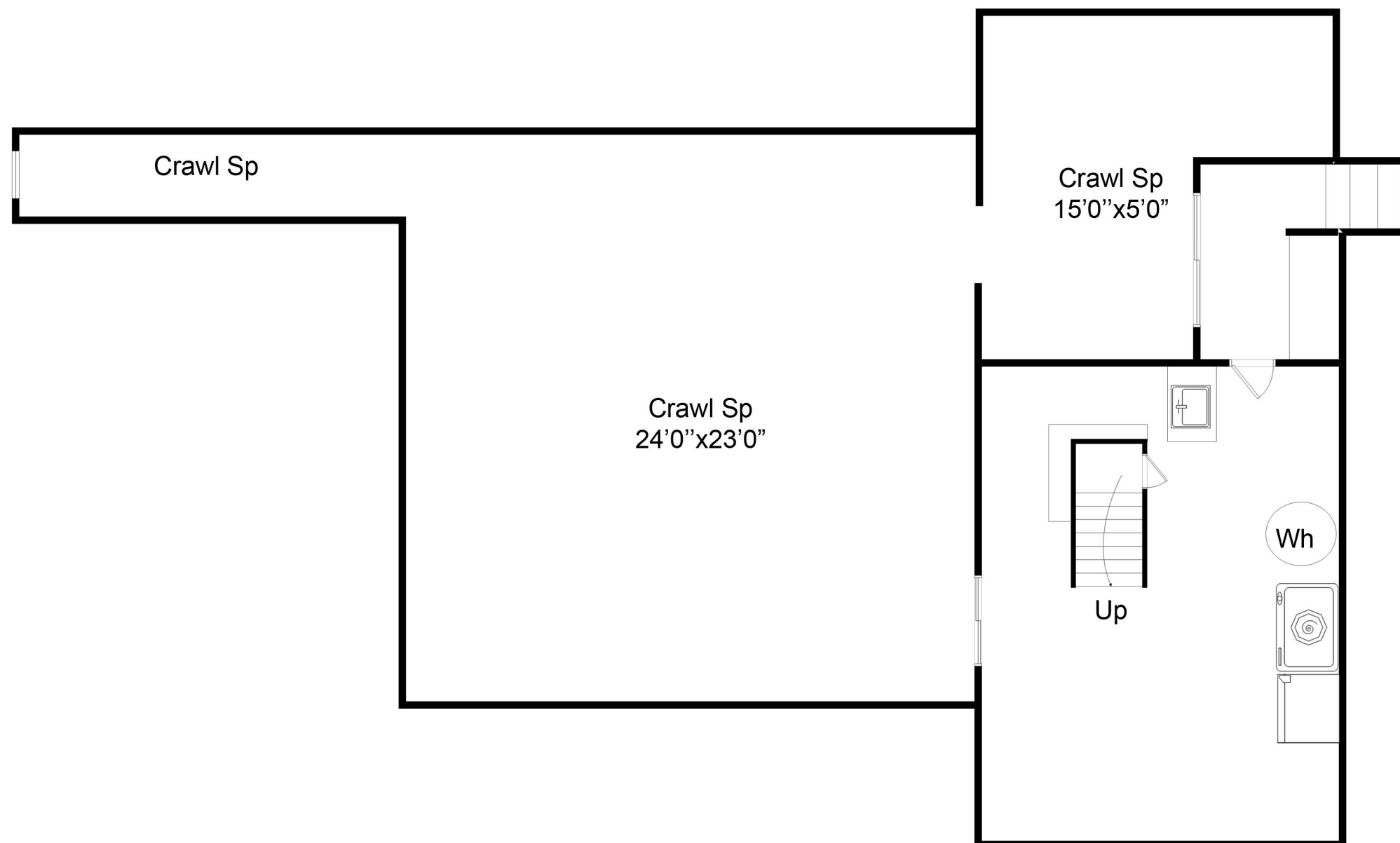

BASEMENT PLAN

First Floor: 1,932 Sq Ft
Back Patio: 1,266 Sq Ft
Front Patio: 265 Sq Ft
Basement: 363 Sq Ft
Crawlspace: 802 Sq Ft

Floor plan, furniture, and fixture measurements and dimensions are approximate and are for illustrative purposes only. Corcoran gives no guarantee, warranty or representation as to the accuracy and completeness of the floor plan

76 Jack & Jill Dr, Bridgehampton, NY 11932