

SURVEYED FOR
 PROPERTY LOCATED AT THE INC VILLAGE OF SAG HARBOR
 TOWN OF EAST HAMPTON
 SUFFOLK COUNTY, NEW YORK
 S.C.T.M. # 302-05-01-23
 AREA = 3,443 SF = 0.079 AC
 SCALE: 1"=20'

FEB 2 '20 PM 8:00

NOTE: THE EXISTENCE OF RIGHT OF WAYS,
 WETLANDS AND/OR EASEMENTS OF RECORD
 IF ANY, NOT SHOWN ARE NOT GUARANTEED.

COVERAGE CALCULATIONS:

ALLOWABLE BUILDING COVERAGE = 20% = 689 SF
 EXISTING BLDG COVERAGE = 30.3% = 1,043 SF

ALLOWABLE TOTAL COVERAGE = 25% = 861 SF
 EXISTING TOTAL COVERAGE = 48.2% = 1,660 SF

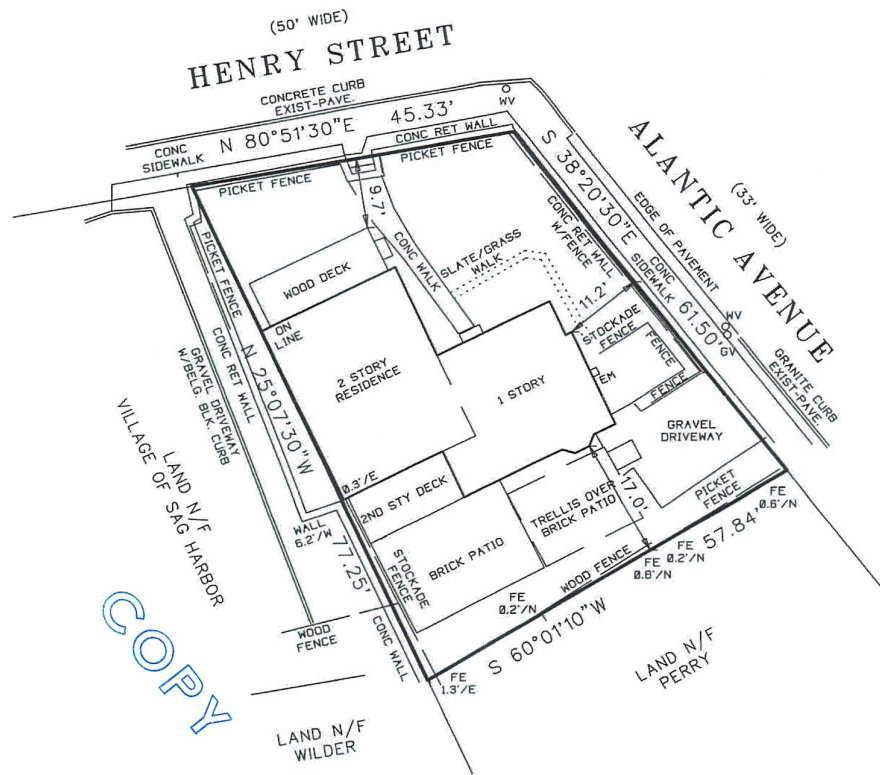

COPY

UNAUTHORIZED ALTERATION OR ADDITION TO THIS SURVEY IS A VIOLATION
 OF SECTION 7209 OF THE NEW YORK STATE EDUCATION LAW.

COPIES OF THIS SURVEY MAP NOT BEARING THE LAND SURVEYORS INKED
 OR EMBOSSED SEAL SHALL NOT BE CONSIDERED TO BE A VALID TRUE COPY.

GUARANTEES OR CERTIFICATIONS INDICATED HEREON SHALL RUN ONLY TO
 THE PERSON FOR WHOM THE SURVEY IS PREPARED, AND ON HIS BEHALF TO
 THE TITLE COMPANY, GOVERNMENTAL AGENCY AND LENDING INSTITUTION
 LISTED HEREON, AND TO THE ASSIGNEES OF THE LENDING INSTITUTION.
 GUARANTEES OR CERTIFICATIONS ARE NOT TRANSFERABLE TO ADDITIONAL
 INSTITUTIONS OR SUBSEQUENT OWNERS.

CERTIFIED TO:

NEW YORK TITLE ABSTRACT SERVICES, INC
 OLD REPUBLIC NATIONAL TITLE INS CO.

John Barylski

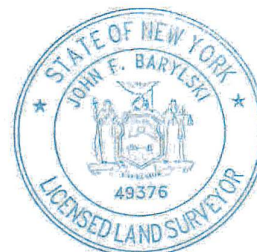

SURVEYED BY:
 BARYLSKI LAND SURVEYING
 2320 MAIN ST. P.O. BOX 1302
 NEWMAN VILLAGE CONDO.
 BRIDGEHAMPTON, NEW YORK
 (631-537-7944)
 NOVEMBER 16, 2022

M:\GXD\05753.gxd - 12/09/2022 - 12:59 PM - Scale 1:240.0