

JOB NO. 2018-165
MAP NO.
FILED:
REVISIONS:

LICENSE NO.050363

HANDS ON SURVEYING

26 SILVER BROOK DRIVE
FLANDERS, NEW YORK
11901
TEL: (631)-369-8312 - FAX:(631)-369-8313
MARTIN D. HAND L.S



COPIES OF THIS SURVEY MAP, EITHER PAPER OR ELECTRONIC, NOT BEARING
THE LAND SURVEYORS INKED SEAL OR EMBOSSED SEAL SHALL NOT BE
CONSIDERED TO BE A VALID COPY AND SHALL NOT BE USED FOR ANY PURPOSE.

SURVEY OF
DESCRIBED PROPERTY
SITUATE AT
REMSENBURG

TOWN OF SOUTHAMPTON
SUFFOLK COUNTY, NEW YORK
S.C.T.M. DIST. 0900 SEC. 381 BLK. 02 LOT 2.3

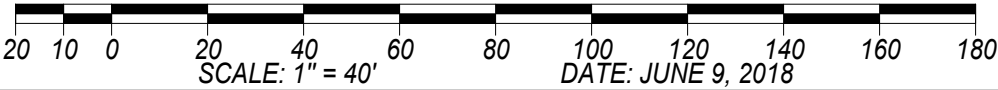

CERTIFIED TO: JLL SOUTH COUNTRY, LLC
SAFE HARBOR TITLE AGENCY
AS AGENTS FOR FIRST AMERICAN TITLE INSURANCE COMPANY

SOUTH COUNTRY ROAD

MAIN STREET (POST ROAD)

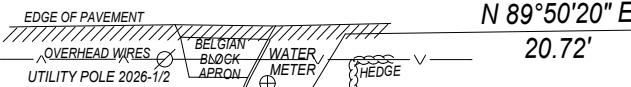

S 89°53'00" W 178.20'

SHORE ROAD

LAND NOW OR FORMERLY OF
DAVID STARR

PARCEL ALSO KNOWN AS PARCEL 2 AS SHOWN ON THE
MINOR SUBDIVISION MAP OF SARAJANE GIERE,
APPROVED BY THE TOWN OF SOUTHAMPTON PLANNING BOARD
MARCH 24, 1977 AND FILED AS MAP NO. 131.

LOT AREA: 40,454 SQ.FT. = 0.929 ACRE
ELEVATIONS HEREON REFER TO NAVD 1988
CURRENT ZONING: R-40 STORMWATER MANAGEMENT ZONE
WATER QUALITY IMPROVEMENT OVERLAY - HIGH PRIORITY
ALL PROPERTIES WITHIN 150' OF SUBJECT BOUNDARY
ARE IMPROVED AND SERVICED BY PUBLIC WATER

LAND NOW OR FORMERLY OF
DAVID BUTLAND

PARCEL 1

LOT 44

LAND NOW OR FORMERLY OF
8 SHORE RD. ASSOCIATES, LLC

ASPHALT DRIVEWAY
BELGIAN BLOCK CURB

VACANT
LAND

LAND NOW OR FORMERLY OF
THE PADAVAN IRREVOCABLE TRUST

PARCEL 3
LAND NOW OR FORMERLY OF
JOEL SPORN

SUBDIVISION MAP OF ROGER VASSELAIS - SECTION 2
FILED IN THE OFFICE OF THE CLERK OF THE COUNTY OF SUFFOLK
ON FEBRUARY 19, 1988 AS MAP NO.: 5043

EASEMENT AND/OR SUBSURFACE
STRUCTURES RECORDED OR
UNRECORDED ARE NOT GUARANTEED
UNLESS PHYSICALLY EVIDENT AT THE
TIME OF SURVEY.

THE OFFSET (OR DIMENSIONS) SHOWN
HEREON FROM THE STRUCTURES TO THE
PROPERTY LINES ARE FOR A SPECIFIC
PURPOSE AND USE AND THEREFORE
ARE NOT INTENDED TO GUIDE THE
ERECTION OF FENCES, RETAINING
WALLS, POOLS, PATIOS, PLANTING
AREAS, ADDITIONS TO BUILDINGS
AND ANY OTHER CONSTRUCTION.

UNAUTHORIZED ALTERATION OR ADDITION
TO THIS SURVEY IS A VIOLATION OF
SECTION 7209 OF THE NEW YORK STATE
EDUCATION LAW.

COPIES OF THIS SURVEY MAP NOT BEARING
THE LAND SURVEYORS INKED SEAL OR
EMBOSSED SEAL SHALL NOT BE CONSIDERED
TO BE A VALID TITLE COPY.

CERTIFICATIONS INDICATED HEREON SHALL RUN
ONLY TO THE PERSON(S) FOR WHOM THE SURVEY
IS PREPARED AND ON HIS BEHALF TO THE
TITLE COMPANY, GOVERNMENTAL AGENCY AND
LENDING INSTITUTION LISTED HEREON, AND
TO THE ASSIGNEES OF THE LENDING INSTI-
TUTION. CERTIFICATIONS ARE NOT TRANSFERABLE
TO ADDITIONAL INSTITUTIONS OR SUBSEQUENT
OWNERS.