

SURVEY OF DESCRIBED PROPERTY SITUATED AT NOYACK, TOWN OF SOUTHAMPTON SUFFOLK COUNTY, NEW YORK

S.C.T.M. NO. 900-22-01-62.6
 AREA = 353,151.85 SQ. FT. / 8.107 ACRES
 ELEVATIONS ARE USGS DATUM
 MAXIMUM CLEARING ALLOWED = 15%
 EXISTING CLEARED AREA = 45,082 SQ. FT./12.8%

CERTIFIED TO:
 1854 NOYACK PATH LLC
 LAWYERS TITLE INSURANCE CORPORATION
 MIDFIRST BANK ITS SUCCESSORS AND/OR ASSIGNS

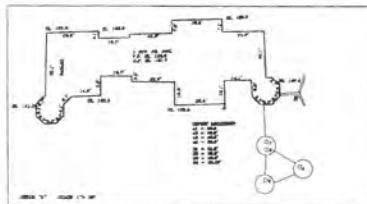

GUARANTEES OR CERTIFICATIONS ARE NOT TRANSFERABLE. UNDERGROUND UTILITIES, EASEMENTS NOT SHOWN AND UTILITY POLE LOCATIONS ARE NOT GUARANTEED. THE OFFSET DIMENSION SHOWN HEREON FROM THE STRUCTURES TO THE PROPERTY LINES ARE FOR SPECIFIC PURPOSE AND USE. THEREFORE ARE NOT INTENDED TO GUIDE THE DIRECTION OF FENCES, RETAINING WALLS, POOLS, PATIOS, PLANTING AREAS, ADDITION TO BUILDINGS AND OTHER CONSTRUCTION. THE EXISTENCE OF RIGHT OF WAYS, WETLANDS AND/OR EASEMENTS OF RECORD, IF ANY, NOT SHOWN ARE NOT GUARANTEED. UNAUTHORIZED ALTERATION OR ADDITION TO THIS SURVEY IS A VIOLATION OF SECTION 7209 OF THE NEW YORK STATE EDUCATION LAW. COPIES OF THIS SURVEY MAP NOT BEARING THE LAND SURVEYORS SIGNATURE AND RED INK OR EMBOSSED SEAL SHALL NOT BE CONSIDERED A TRUE VALID COPY.

UPDATE: 06/08/2007
 REVISED: 04/14/2005 (WELL LOCATION)
 DATE: 9/30/2004

FILE NO. 50380 SCALE: 1" = 80'



PAT T. SECCAFICO
 PROFESSIONAL LAND SURVEYOR, P.C.
 - SUCCESSOR TO -
 DONALD TASE, L.S.
 RICHARD WILHELM AND ASSOCIATES
 NORTHSTAR SURVEYING, P.C.
 PAUL T. CANALIZO, L.S., ROBERT A. KART, L.S.
 GOOD GROUND SURVEYORS, P.C.
 328A Main Street Center, Mariches, NY 11934
 Phone: (631) 878-0120
 Fax: (631) 878-7190
 107-5 W. Montauk Highway Hampton Bays, NY 11946
 Phone: (631) 728-5330
 Fax: (631) 728-6707
 N.Y.S. LIC. NO. 049287
 COPYRIGHT - 2007 PAT T. SECCAFICO P.L.S., P.C.